

#56294

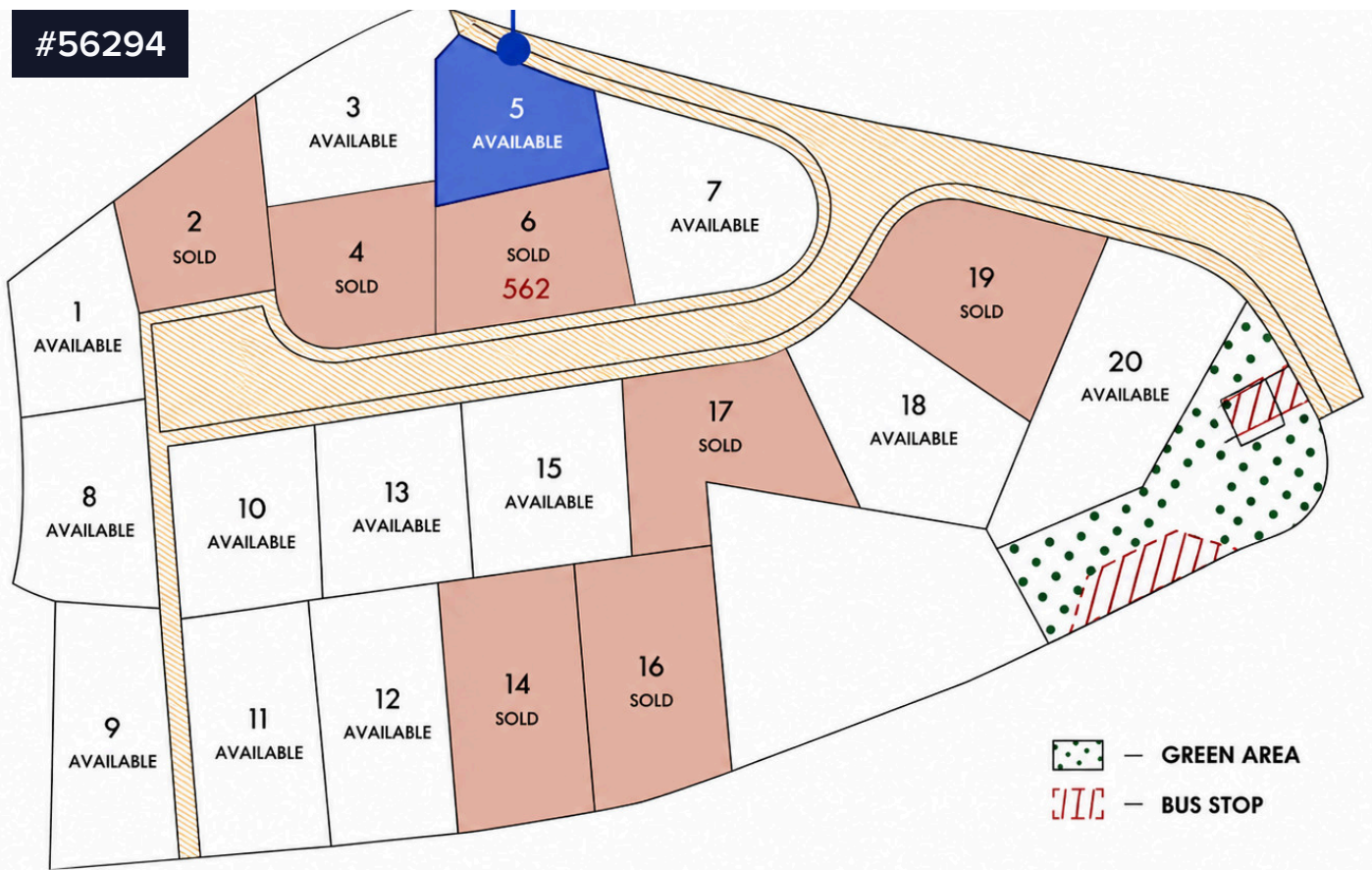

## Excellent Location Land Within Residential Zone in Kalavassos Village, Larnaca

€79,000 +VAT

Kalavassos, Larnaca

Area

410 m<sup>2</sup>

Type

Development Land

Excellent Location Land Within Residential Zone in Kalavassos Village, Larnaca. Situated just before the entrance of Kalavassos Village, this property enjoys a desirable location within a newly developed and peaceful residential area. It offers easy access to everyday amenities, including supermarkets, traditional taverns, and local services, while Limassol can be reached in approximately 15 minutes by car.

The property is currently under division and corresponds to Plot No. 5, with an area of approximately 410 sq.m. It falls within the H3 Residential

